

# Elm Park House, Fulham Road, SW10

Approximate Gross Internal Area = 72.3 sq m / 778 sq ft

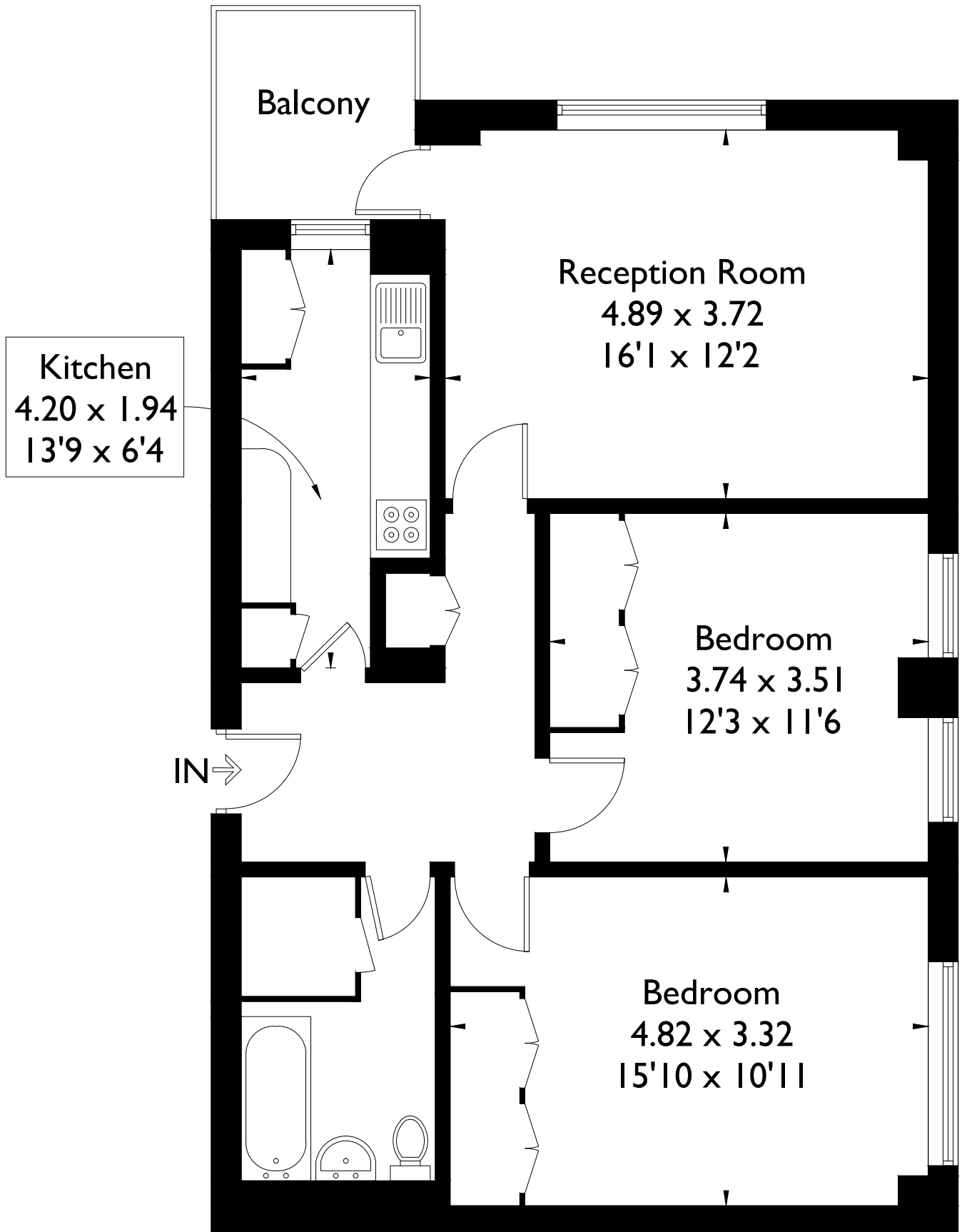

FLOORPLANZ © 2015 0845 6344080 Ref: 156457

This plan is for layout guidance only. Drawn in accordance with RICS guidelines. Not drawn to scale unless stated. Windows & door openings are approximate. Whilst every care is taken in the preparation of this plan, please check all dimensions, shapes & compass bearings before making any decisions reliant upon them.